

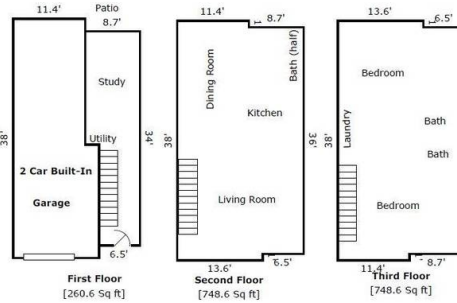

Jerry Helmer  
 HELMER, JERRY L  
 734-368-1733

\$231,000

133 S 2nd St, Brighton, MI



|                 |                   |               |                 |
|-----------------|-------------------|---------------|-----------------|
| Condo           | Mid-rise Building | 2 Bedrooms    | 2 Full Baths    |
| 1 Half Bath     | 1757 Sq. Ft.      | Built in 2003 | Open Kitchen    |
| 1 Fireplace     | Natural Gas       | Central A/C   | Attached Garage |
| 2 Garage Spaces | Patio             |               |                 |

2 Bedroom 3 Story Condo in Brighton, MI w/ attached garage This Main Street Crossing Condo in Brighton, MI provides 1758 Sq Ft with a two car attached garage with an additional 472 Sq Ft. It has a main floor study with utility space. Second floor has dining room, Living room, Kitchen w/ appliances, and half bath. The third floor has two large bedrooms with full baths and laundry. Small patio on main floor. This brick Condo is close to shopping & restaurants in a thriving Brighton Community. Brighton Schools & close to US 23 and I - 96. Carpets have been removed and some updates are necessary